

Catalog Number: _____ Type: _____

Project: _____

Comments: _____ Date: _____

Linear LED Vaportight High Performance Luminaire



Linear Vaportight High Performance Luminaires are energy efficient alternatives to linear fluorescents. The performance engineered LED technology delivers consistent color and CRI for a uniform installation and improves lumen maintenance for long useful rated life. Linear Vaportight High Performance Luminaires offers 0-10V dimming, motion control and emergency options, all without changing the form factor. Luminaires are IP65 Rated for outdoor use.¹ Applications include building warehouses, gas stations, parking garages stairwells, car washes and manufacturing. The Luminaires are backed by a 5-Year Warranty.

¹ IP65 Rated luminaires are rated for use outdoors where exposed directly to water from rain or irrigation.

Performance Specifications

CRI _____	80	Min. Start Temp. _____	-22°F (-30°C)
Rated Life _____	160,000 hour life	Max. Operating Temp. _____	122°F (50°C)
Watt _____	40W, 80W	Power Factor _____	>0.98%
Lumens _____	5,200, 10,400	THD _____	<20%
Lumens per Watt (LPW) _____	130	Warranty _____	5-Year Limited
Input Line Voltage _____	100-277V	Control _____	(0-10V) Select Models
Input Line Frequency _____	50/60 Hz	Weight _____	6.0 lbs.

Energy Savings

System	System Wattage	Replacement LED	Wattage	Energy Savings
3 Lamp Fluorescents	96W	LVT4CL40/850/5S/LED/MC	40W	67%

Construction

- Polycarbonate lens
- Omnidirectional for optimal lighting
- IP65 rated

Accessories

- Vaportight Mounting Assembly (Mounting bracket, Aircraft Cable, and Hardware) - LVTH4CL/MA - 99628
- Vaportight Motion/Photo Control Wireless Remote - LVTH4CL/WR - 99629
- Vaportight Linkable Cable - LVTH4CL/LC - 99630

Installation

- Stainless steel clips (Standard)
- Suspension cable (Standard)
- Ceiling or wall mount
- Operating temperature range is -22°F (-50°C) to 122°F (50°C)

Electrical

- 100V-277V input range
- UL listed for wet locations
- 50/60 Hz input frequency
- Voltage sensing 100-277V dimmable driver (Select models)
- Dimmable (Select models)
- Emergency (Select models)
- Motion sensor (Select models)
- Linkable

Ordering Information



Watt	Product #	Product Code	Volts	Color Temp.	CRI	Lumens	Useful Life*	Dimmable	DLC Product ID	Luminaire Size W x H	Wattage Equivalent
40 Watt	99622	LVTH4CL40/850/3S/LED	100-277V	5000K	80	5,200	160,000	No	PL5YSPO16UQV	47.24" (1200 mm) x 4.29" (109mm)	3-lamp (T8)
80 Watt	99623	LVTH4CL80/850/3S/LED	100-277V	5000K	80	10,400	160,000	No	PLPQT550D00R	47.24" (1200 mm) x 4.29" (109mm)	4-lamp (T8)/3-lamp (T5HO)
40 Watt	99624	LVTH4CL40/850/3S/LED/MC	100-277V	5000K	80	5,200	160,000	Yes (0-10V)	PL5YSPO16UQV	47.24" (1200 mm) x 4.29" (109mm)	3-lamp (T8)
80 Watt	99625	LVTH4CL80/850/3S/LED/MC	100-277V	5000K	80	10,400	160,000	Yes (0-10V)	PLPQT550D00R	47.24" (1200 mm) x 4.29" (109mm)	4-lamp (T8)/3-lamp (T5HO)
40 Watt	99626	LVTH4CL40/850/3S/LED/EM	100-277V	5000K	80	5,200	160,000	No	PL5YSPO16UQV	47.24" (1200 mm) x 4.29" (109mm)	3-lamp (T8)
80 Watt	99627	LVTH4CL80/850/3S/LED/EM	100-277V	5000K	80	10,400	160,000	No	PLPQT550D00R	47.24" (1200 mm) x 4.29" (109mm)	4-lamp (T8)/3-lamp (T5HO)

* Useful Life is defined as the point in time at which the lamp will maintain at least 70% of its initial lumens. The lamp will continue to operate past this point at decreased light levels. May not be compatible with all dimming systems, dimming performance may vary by system. Requires a 0-10V dimmer, with 2 additional wires for dimming control.

Warranty – Commercial / Industrial: This product is warranted for 5 years from the date of purchase. Mounting hardware included with all luminaires.

** Check the latest update at www.DesignLights.org for listed product catalog numbers. Not all versions are listed.



Linear LED Vaportight High Performance Luminaire

Dimensions

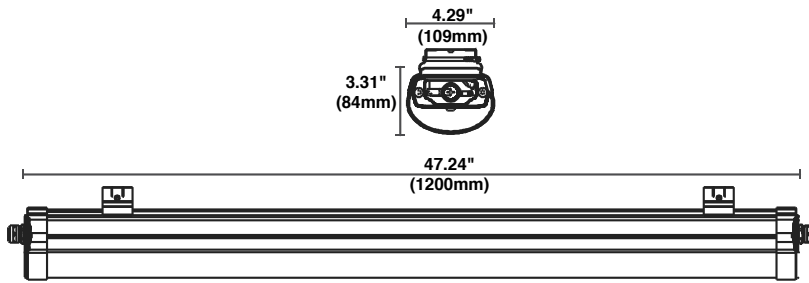

Ambient Temperature	Rated Life
77°F(25°C)	160,000 Hours
86°F(30°C)	120,000 Hours
95°F(35°C)	80,000 Hours
104°F(40°C)	60,000 Hours
113°F(45°C)	55,000 Hours
122°F(50°C)	50,000 Hours

Accessories



Linkable Cable - LVTH4CL/LC - 99630



Motion/Photo Control Wireless Remote - LVTH4CL/WR - 99629

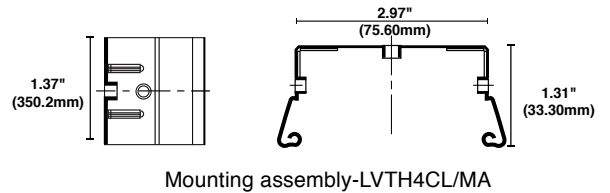
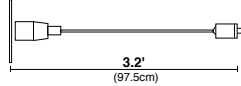
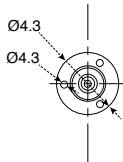
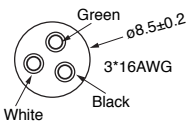

Mounting assembly-LVTH4CL/MA

Photometrics

Polar Candela Distribution Plot LVTH4CL40/850/3S/LED

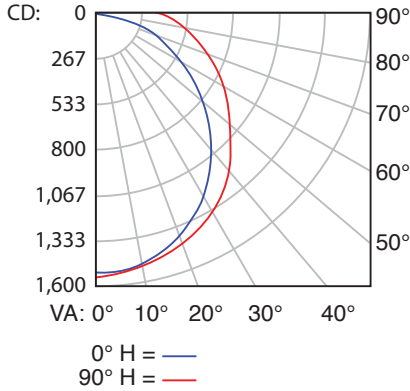

LUMENS PER ZONE					
ZONE	LUMENS	% TOTAL	ZONE	LUMENS	% TOTAL
0-10	144.5	2.7%	90-100	203.1	3.8%
10-20	411.9	7.7%	100-110	133.2	2.5%
20-30	619.7	11.6%	110-120	86.0	1.6%
30-40	742.9	13.9%	120-130	54.2	1%
40-50	774.1	14.5%	130-140	33.4	0.6%
50-60	721.8	13.5%	140-150	20.5	0.4%
60-70	605.5	11.4%	150-160	12.2	0.2%
70-80	453.7	8.5%	160-170	6.3	0.1%
80-90	307.7	5.8%	170-180	1.9	0%

ZONAL LUMEN SUMMARY			
ZONE	LUMENS	% LAMP	% LUMINAIRE
0-30	1,176.1	22.1%	22.1%
0-40	1,918.9	36%	36%
0-60	3,414.9	64.1%	64%
60-90	1,366.9	25.6%	25.6%
70-100	964.5	18.1%	18.1%
90-120	422.3	7.9%	7.9%
0-90	4,781.8	89.7%	89.7%
90-180	550.8	10.3%	10.3%
0-180	5,332.6	100%	100%

ILLUMINANCE AT A DISTANCE

HEIGHT (FT)	CENTER BEAM		BEAM SPREAD (FT)		FIELD SPREAD (FT)	
	FOOTCANDLE	HORIZONTAL	HORIZONTAL	VERTICAL	HORIZONTAL	VERTICAL
2.00	381.14 FC	8.3	5.0	18.7		
4.00	95.29 FC	16.6	10.0	37.3		
6.00	42.35 FC	25.0	15.0	56.0		
8.00	23.82 FC	33.3	20.0	74.7		
10.00	15.25 FC	41.6	24.9	93.4		

BEAM ANGLE	FIELD ANGLE
128.7°	N/A 155.8°

Polar Candela Distribution Plot LVTH4CL80/850/3S/LED

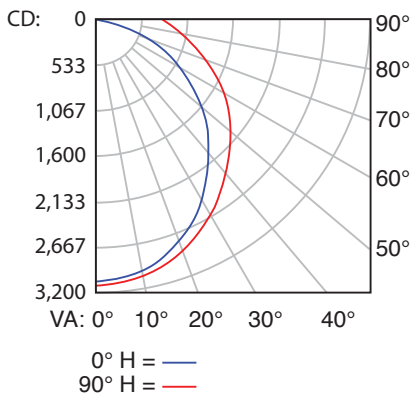

LUMENS PER ZONE					
ZONE	LUMENS	% TOTAL	ZONE	LUMENS	% TOTAL
0-10	290.5	2.8%	90-100	397.8	3.8%
10-20	827.1	7.9%	100-110	257.6	2.4%
20-30	1,240.6	11.8%	110-120	163.2	1.6%
30-40	1,479.5	14.1%	120-130	101.0	1%
40-50	1,530.8	14.5%	130-140	61.9	0.6%
50-60	1,417.3	13.5%	140-150	38.2	0.4%
60-70	1,185.1	11.3%	150-160	23.0	0.2%
70-80	891.1	8.5%	160-170	11.7	0.1%
80-90	606.8	5.8%	170-180	3.4	0%

ZONAL LUMEN SUMMARY			
ZONE	LUMENS	% LAMP	% LUMINAIRE
0-30	2,358.2	22.4%	22.4%
0-40	3,837.6	36.5%	36.5%
0-60	6,785.7	64.5%	64.5%
60-90	2,683.0	25.5%	25.5%
70-100	1,896.7	18%	18%
90-120	818.5	7.8%	7.8%
0-90	9,468.7	90%	90%
90-180	1,057.7	10.1%	10%
0-180	10,526.4	100%	100%

ILLUMINANCE AT A DISTANCE

HEIGHT (FT)	CENTER BEAM		BEAM SPREAD (FT)		FIELD SPREAD (FT)	
	FOOTCANDLE	HORIZONTAL	HORIZONTAL	VERTICAL	HORIZONTAL	VERTICAL
2.00	768.78 FC	8.2	4.8	18.3		
4.00	192.19 FC	16.4	9.7	36.7		
6.00	85.42 FC	24.6	14.5	55.0		
8.00	48.05 FC	32.8	19.3	73.3		
10.00	30.75 FC	41.0	24.2	91.7		

BEAM ANGLE	FIELD ANGLE
128.0°	N/A 155.4°